

the Legendary
ROY WILKINS™
AUDITORIUM

Facility Specifications

Upper Level

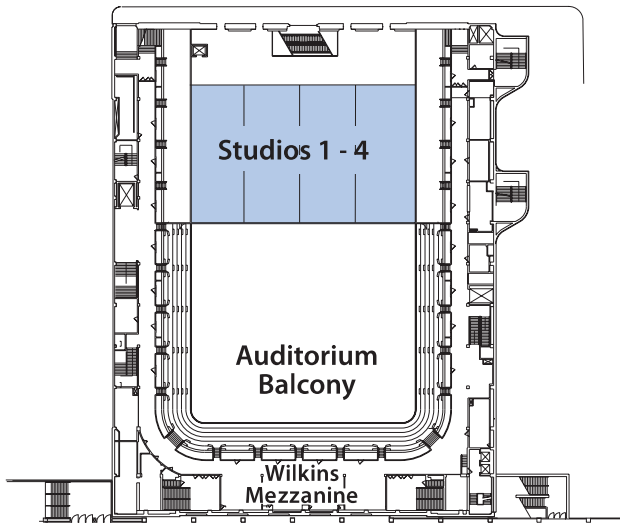

Street Level

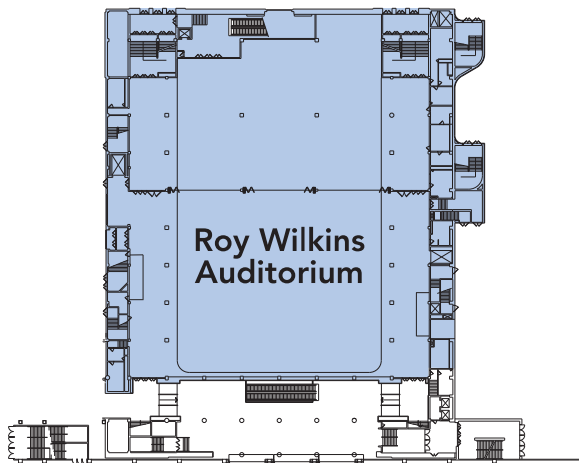

Lower Level

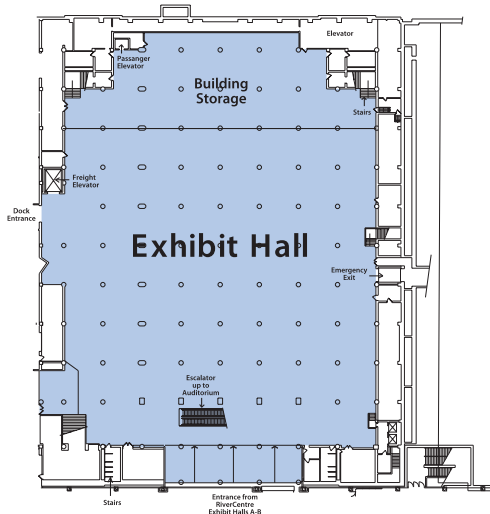

Dimensions

Total Floor Size	225' x 200'	45,000 sq.ft.
Auditorium Floor Size	125' x 200'	25,000 sq. ft.
Backstage Floor Size	100' x 200'	20,000 sq. ft.

Auditorium Ceiling Height*	52' - 60'
	(88' to high steel for rigging)
Backstage (North Forum) Ceiling Height	20'
Under Balcony Ceiling Height	11' 9.5"

*Varies depending on beam location

Capacities

Concert	Balcony (Permanent seats)	3,650
	Floor (Reserved seats)	1,500
	Floor (General Admission)	2,200
Banquet	2,300	
Reception	3,500	
Classroom (South Forum)		

Dressing Rooms

All rooms are located backstage.

Production Office	14' x 19'
Dressing Room #1*	14' x 18'
Dressing Room #2	14' x 12'
Dressing Room #3	14' x 13'
Dressing Room #4*	14' x 22'

*Dressing rooms with private bathroom

Loading Docks

Upper Loading Door	25' wide x 11'4" high
Lower Loading Docks	Service via freight elevator 3 dock bays available.

Truck Staging

Upper Loading Ramp	5th Street cut out
--------------------	--------------------

Basketball

Floor Size	112' x 60'
------------	------------

Electrical

Stage Power	1 - 400 amp stage left 1 - 400 amp stage right 1 - 400 amp upstage Electrical Service Form Available
Exhibitor Power	

Concession Stands

4 - 2 Balcony, 2 Auditorium Floor and additional, temporary concession stands available

Equipment

Forklifts	(3), 6000 lbs. (Extensions available)
Barricade	Normal 160'
Pipe/Drape	300' Black
Piano	Yamaha Baby Grand - Aerosonic Upright
Under Balcony Masking	

Technical

Stagehand/AV Labor	I.A.T.S.E. Local Thirteen
Staging	SICO, 8' x 8' sections, adjustable height 48" - 72" 6' x 8' sections available at 8", 16", 24" and 32" Camera Risers, 8' x 4', adjustable to variable heights* *Call for additional equipment needs

Stage Lighting	40 1k Lekos on motorized downstage truss 8 High End Studio Spots CMY - 575 watt on motorized upstage truss 3 Martin Mac 2000's on motorized downstage truss
----------------	--

Followspots	6, 1.6K Super Troopers, fixed positions 4, Lycian Arc 400, portable
-------------	--

Sound System	Flown JBL/Crown Full Range Left/Right Array Upstage Center Cluster for fill and special coverage Full Range Delay/Balcony Speakers Full Concert System Available Including: - Additional floor stacked Full Range Speakers - Subs, Floor Monitors, Processing - Soundcraft MH3 FOH and Monitor Consoles
--------------	---

Black Backdrop	30' high x 80' wide
----------------	---------------------

Rigging	Diagram available
---------	-------------------

Room/House Lighting	MH/Incandescent
---------------------	-----------------